

BESPOKE - Counter tops with a thickness of 16 mm



Exterior finishes



Technical Characteristics

Front & side panels (Thickness=16mm):

- Gloss White: Laminated particle board lacquered with UV high gloss polyester paint.
- Natural, African oak, Walnut Oak, Gloss White, White Satin, Black Satin, Blue Satin, Green Satin, Red Satin: Laminated particle board.

* All the panels used in the manufacture of this unit are classed as E-05 grade with low level of formaldehyde content.

*Trim varies according to design: PVC, ABS (edged with PUR glue)

Packaging dimensions and weight

	600	700	800	900	1000	1200
Lenght (mm)	625	755	825	955	1025	1255
Depth (mm)	481	495	481	495	481	515
Height (mm)	60	40	60	40	60	95
Net weight (kg)	3,1	3,5	4,1	4,5	5,2	6,2
Gross weight (kg)	3,9	4	4,8	5,1	5,9	7,2

Machining options

For countertop or semi-recessed basins

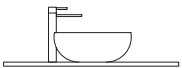

For one or two basins

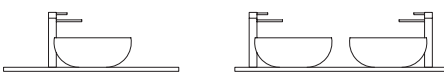

With countertop or wall-mounted basins



Dimensions

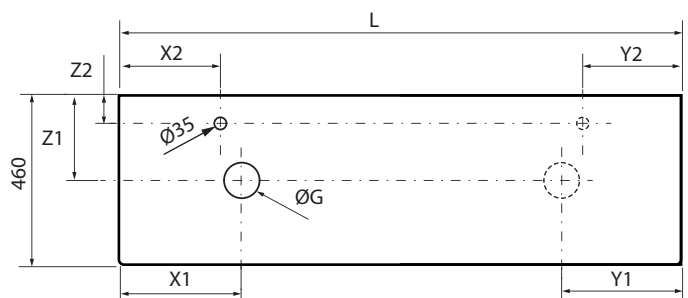

Top basins for combination

Top basins:

Altiro, Seduction, Kandy, Lokum, Verila, Nesla, Bol, Bulkan, Bica, Talea.

Semi inset basins

Mael

Order forms

Order forms necessary for custom countertops.

